

NO.	BILL	UNIT	SIZE	NO.	BILL	UNIT	SIZE
D1	2150	1100X1150	W	1100	2150	2400X1800	
D2	2150	800X1150	W2	350	2150	1600X1800	
D3	2150	780X2180	W2A	350	2150	1600X1800	
D4	2150	1900X1180	W3	350	2150	1100X1800	
DW	2150	2180X1150	W4	350	2150	850X1800	
F.C.D.	2150	1300X1150	WB	1100	2150	800X1050	
			WB	1250	2150	600X900	
			SW	880	2150	1200X1800	
			V	1750	2550	1200X550	

CERTIFICATE OF OWNER
 CERTIFIED THAT I HAVE GONE THROUGH THE BUILDING RULES FOR RAJAPUR MUNICIPALITY AND ALSO UNDER TAKE TO ABIDE BY THOSE RULES DURING AND AFTER CONSTRUCTION OF THE BUILDING.

SRINANI REALTY PVT. LTD. & ORS
(Signature)
 Authorizing Signatory

SIGNATURE OF OWNER

CERTIFICATE OF STRUCTURAL STABILITY
 WE HEREBY CERTIFY THAT THE FOUNDATION AND SUPERSTRUCTURE OF THE BUILDING PROPOSED FOR CONSTRUCTION OF R. GANNO, 304, 305, 307, 308, 310 TO 315, 552 TO 558, 559, 530, 535, 536, 539 TO 542, 545-548, 573, 574, 462, 587, 588, 572, 587, 589, 590 TO 593, 595, 596, 597, 598, 600, 601, 602, 603, 604, 605, 606, 607, 608, 609, 610, 611, 612, 613, 614, 615, 616, 617, 618, 619, 620, 621, 622, 623, 624, 625, 626, 627, 628, 629, 630, 631, 632, 633, 634, 635, 636, 637, 638, 639, 640, 641, 642, 643, 644, 645, 646, 647, 648, 649, 650, 651, 652, 653, 654, 655, 656, 657, 658, 659, 660, 661, 662, 663, 664, 665, 666, 667, 668, 669, 670, 671, 672, 673, 674, 675, 676, 677, 678, 679, 680, 681, 682, 683, 684, 685, 686, 687, 688, 689, 690, 691, 692, 693, 694, 695, 696, 697, 698, 699, 700, 701, 702, 703, 704, 705, 706, 707, 708, 709, 710, 711, 712, 713, 714, 715, 716, 717, 718, 719, 720, 721, 722, 723, 724, 725, 726, 727, 728, 729, 730, 731, 732, 733, 734, 735, 736, 737, 738, 739, 740, 741, 742, 743, 744, 745, 746, 747, 748, 749, 750, 751, 752, 753, 754, 755, 756, 757, 758, 759, 760, 761, 762, 763, 764, 765, 766, 767, 768, 769, 770, 771, 772, 773, 774, 775, 776, 777, 778, 779, 780, 781, 782, 783, 784, 785, 786, 787, 788, 789, 790, 791, 792, 793, 794, 795, 796, 797, 798, 799, 800, 801, 802, 803, 804, 805, 806, 807, 808, 809, 810, 811, 812, 813, 814, 815, 816, 817, 818, 819, 820, 821, 822, 823, 824, 825, 826, 827, 828, 829, 830, 831, 832, 833, 834, 835, 836, 837, 838, 839, 840, 841, 842, 843, 844, 845, 846, 847, 848, 849, 850, 851, 852, 853, 854, 855, 856, 857, 858, 859, 860, 861, 862, 863, 864, 865, 866, 867, 868, 869, 870, 871, 872, 873, 874, 875, 876, 877, 878, 879, 880, 881, 882, 883, 884, 885, 886, 887, 888, 889, 890, 891, 892, 893, 894, 895, 896, 897, 898, 899, 900, 901, 902, 903, 904, 905, 906, 907, 908, 909, 910, 911, 912, 913, 914, 915, 916, 917, 918, 919, 920, 921, 922, 923, 924, 925, 926, 927, 928, 929, 930, 931, 932, 933, 934, 935, 936, 937, 938, 939, 940, 941, 942, 943, 944, 945, 946, 947, 948, 949, 950, 951, 952, 953, 954, 955, 956, 957, 958, 959, 960, 961, 962, 963, 964, 965, 966, 967, 968, 969, 970, 971, 972, 973, 974, 975, 976, 977, 978, 979, 980, 981, 982, 983, 984, 985, 986, 987, 988, 989, 990, 991, 992, 993, 994, 995, 996, 997, 998, 999, 1000.

(Signature)
JISHNU PAL
 B.Tech (Mechanical) 22RJPSCWG-T/12016-17
 I/MC Reg. No.: GT/1/32

SIGN OF GEO-TECH. ENGG.

(Signature)
Mainak Majumdar
 B.E., M.C.E. (Struct)
 ESE-12/14/2016
 STER/INDA/10/0020
 07/RJPSCWB/EST/132

SIGN OF STRL. ENGG. SIGN OF STRL. REVIEWER

(Signature)
JAY PRAKASH AGRAWAL
 561/RJPSON/EBA/03-04
 SIGN OF ARCHITECT

TITLE
 GROUND, FIRST FLOOR PLAN, TYPICAL FLOOR PLAN (2ND TO 18TH), ROOF PLAN, PART PLAN OF O.H.W. RESERVOIR (BLOCK 10B)

PROJECT
 REVISED PLAN SHOWING ADDITION OF 4 FLOORS IN BLOCK 7 (G-XI) STORED AND NEW ADDITION OF 1 No. (G-XII) STORED - BLOCK 12, 1 No. (G-XIII) STORED - BLOCK 11, 3 Nos. (G-XIV) STORED - BLOCK 8 & 9, 10 (A & B) AND 1 No. (G-XV) STORED - 1 No. (G-XVI) BLOCK OF A RESIDENTIAL COMPLEX COMPRISING 13 (THIRTEEN) BLOCKS AT 132, GHOSHAL, PARA ROAD, WARD No. 25, 45, KATA, AT MOULAZ, MANIKPUR, J.L. No. 72, I.E. DAG NO. 304, 305, 477, 478, 481 TO 483, 485, 486, 488 TO 507, 510 TO 529, 532 TO 538, 539, 550, 556, 558, 559, 562, 545, 546, 571, 574, 490, 507, 498, 572, 587, 589, 590 TO 593, 595, 596, 597, 598, P.S. SONAPUR, SONAPUR MUNICIPALITY, SANCTIONED WIDE B.P. No. - 712C/23/2004, DATED - 30.07.2013, SUBSEQUENTLY REVISED PLAN SANCTIONED WIDE No. 185REV/23/2016, DATED - 18.10.2016 AND CC ISSUED FOR BLOCK 1 (PART I & II) (G-XI) STORED & BLOCK 3 (G-XI) STORED, WIDE REF. No. 280CC/CP/23/2016 DATED 01.01.2018 & BLOCK - 4 (PART I & II) (G-XI) STORED WIDE REF. No. 340CC/CP/23/2018 DATED 04.01.18. AND FURTHER REVISED PLAN SANCTIONED WIDE No. 31REV/23/2016 DATED 13.05.2016 & CC ISSUED FOR COMMERCIAL BLOCK (34) STORED WIDE REF. No. 75CC/CP/23/2016 DATED 04.01.2018 & BLOCK - 5 (PART I & II) (G-XI) STORED WIDE REF. No. 382/CC/CP/23/24 DATED 27.5.2016.

APPROVAL OF S.A.E.
 Checked by *(Signature)*
 For Official Use

APPROVED
 Plan No. *(Signature)* Date: *(Signature)*
 Valid Upto: *(Signature)*

(Signature)
 Dr. Pallab Das
 Assistant Engineer
 In Charge, P.W.D.
 SONAPUR MUNICIPALITY

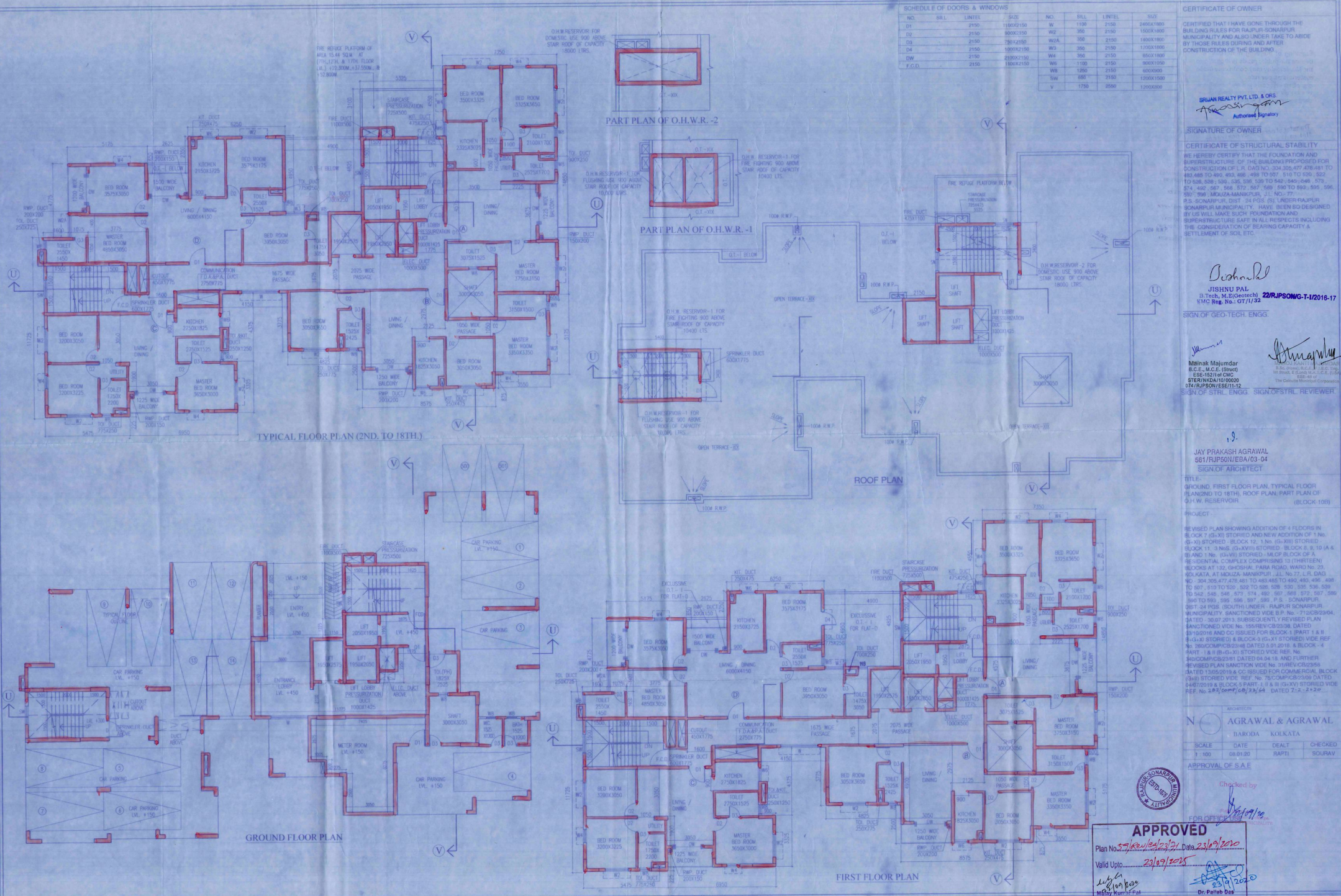

TYPICAL FLOOR PLAN (2ND TO 18TH)

GROUND FLOOR PLAN

FIRST FLOOR PLAN